

Worldwide Charter: EMU Yachting

SCANDINAVIA 35

Fino

The Sailing yacht Scandinavia 35 „Fino“, built in 2024, is moored at the in Marina Drage, - Croatia. The yacht has 3 cabins, can accomodate 6 + 2 persons and has 1 toilet(s) and 0 shower(s).

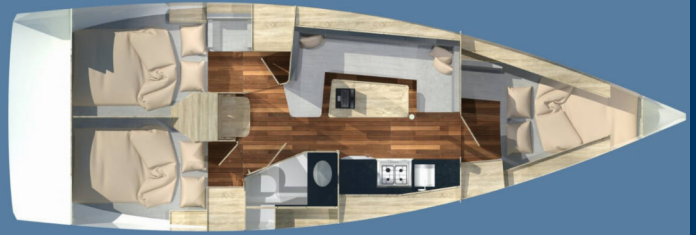

YACHT SPECIFICATIONS

Charter Base

Marina Drage, Croatia

Yacht ID

10838

Brand

Scandinavia Yachts

Name

Fino

Production Year

2024

Length

10.70 m

Cabins

3

Berths

6 + 2

Head

1

STANDARD YACHT EQUIPMENT

Deck

Bimini top, Cockpit cushions, Cockpit table, Cockpit/stern, outside shower, Dinghy, Electric anchor windlass, Fenders, Mooring ropes , Spare anchor (Reserve, Auxiliary anchor), Sprayhood, Teak cockpit

Entertainment

Fusion radio (RA-70N with Bluetooth®, NMEA 2000® + 4 speakers 6,5" 200 W)

Galley

Gas bottles, Hot water, Kitchen utensils (Galley equipment, cutlery), Refrigerator

Interior

Electric toilet

Navigation

Autopilot (Raymarine EV-200 Evolution), Bow thruster, GPS chart plotter - cockpit (RAYMARINE + Navionics), Log, Speed, Depth- echo sounder (Raymarine i70s), Nautical charts, Wind instrument/Anemometer

Safety

Fire extinguisher , First aid kit , Safety equipment

Yacht electrics

Air condition (shore power, 220V), Batteries, Heating (Webasto), Inverter (12V/220V), Shore connection 220 V, VHF radio

Other

Underwater Light

PRICE / WEEKS

13.07. - 20.07.2024 Booked	20.07. - 27.07.2024 Booked	27.07. - 03.08.2024 Booked	03.08. - 10.08.2024 Booked
10.08. - 17.08.2024 2.220 € €3.700	17.08. - 24.08.2024 2.100 € €3.500	24.08. - 31.08.2024 Booked	31.08. - 07.09.2024 Booked
07.09. - 14.09.2024 2.025 € €2.700	14.09. - 21.09.2024 Booked	21.09. - 28.09.2024 Booked	28.09. - 05.10.2024 Booked
05.10. - 12.10.2024 Booked	12.10. - 19.10.2024 938 € €1.250	19.10. - 26.10.2024 938 € €1.250	26.10. - 02.11.2024 938 € €1.250
03.11. - 31.12.2024 Booked			



WEB

www.pitter-yachting.com



PHONE

+43 (0) 3332 66 240



E-MAIL ADDRESS

info@pitter-yachting.com



PITTER YACHTING

Raimund-Obendrauf-Straße 30, 8230, Hartberg, Österreich